

ERITECH[®]

Theft Deterrent Composite Cable

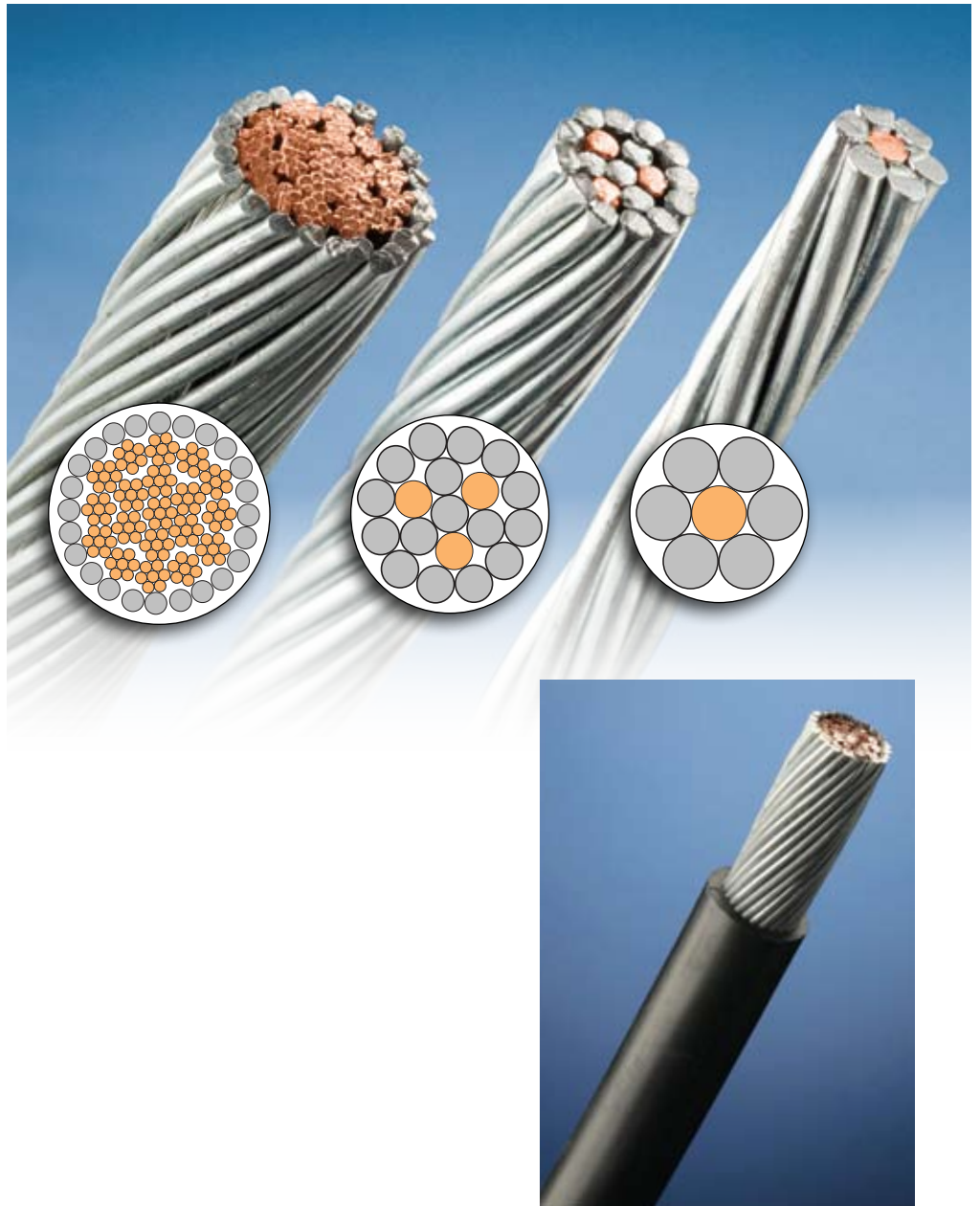

ERICO[®]

Theft Deterrent Composite Cable



Theft deterrent composite cables are bare or insulated concentric stranded conductors that consist of peripheral galvanized steel stranding, which protects and conceals the internal tinned copper strands.

These conductors are ideal for exposed electrical distribution grounding leads where copper theft may occur. These conductors are difficult to cut with hand tools and the outer steel

stranding is magnetic, which further deters thieves looking for copper.

The conductors are suited for use in substation risers to connect the grounding grid to substation equipment and structures. The insulated conductors can be used on power and grounding connections to rail tracks. The CC5A04 (7-strand) and CC5A05 (19-strand) are electrical equivalents to a 4 AWG (16 mm²) and are ideal for transmission tower, distribution pole and street-light, bridge-light or platform-light grounding.

The CC5A04 and CC5A05 have the same outside cable diameter and are compatible with connectors and cable lugs designed for use with 1 AWG (35 mm²) copper cable. The CC5A30 and the cable core of CC5A30INS, as well as CC5A30INSK, have the same outside diameter as 250 kcmil (equivalent diameter to 120 mm² copper cable). They offer an equivalent fusing capacity to 70 mm² copper cable and are compatible with connectors and cable lugs designed for use with 250 kcmil / 120 mm² copper cable.

The black jacket of the insulated cable is a thermoplastic elastomer with UV absorber. The insulation meets 600 V usage and UL® 80° C requirements at a minimum.

Features

- Copper stranding inside of conductor increases conductivity and conductor flexibility
- Copper stranding is tinned for superior corrosion resistance
- Copper strands are hidden by outer galvanized steel strands
- Outer strands comprised of galvanized steel for corrosion resistance
- Insulation meets 600V usage and UL 80° C resistance
- Insulated version is popular for railway applications and is DB approved
- Available in four configurations

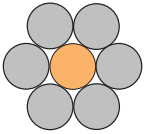
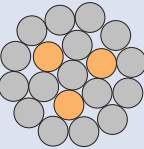
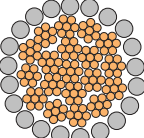
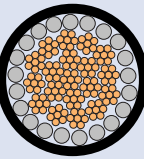
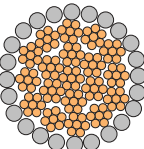
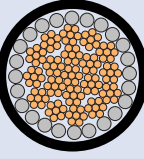
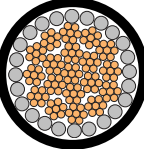
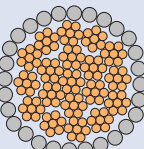
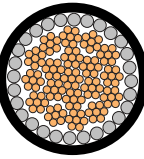

Cable Parts Overview

Global Part Number	Stranding	Cross Section	Resistance	Outside Diameter of Bare Conductor	Fusing Capacity Equivalency	Standard Packaging Quantity	Net Weight	CADWELD® Connection Cable Code
CC5A04	(1) Tinned Copper, (6) Galvanized Steel		0.485 Ω/1,000 ft; 1.499 Ω/km	0.330 in (0.838 cm)	112% of 4 AWG (100% of 16 mm²)	250 ft (76 m)	57 lbs (26 kg)*	S1
CC5A05	(3) Tinned Copper, (16) Galvanized Steel		0.457 Ω/1,000 ft; 1.591 Ω/km	0.334 in (0.848 cm)	113% of 4 AWG (100% of 16 mm²)	250 ft (76 m)	58 lbs (27 kg)*	S1
CC5A20	(133) Tinned Copper, (21) Galvanized Steel		0.098 Ω/1,000 ft; 0.320 Ω/km	0.526 in (1.336 cm)	100% of 2/0 AWG (> 50 mm²)	200 ft (60 m)	109 lbs (50 kg)*	S5
CC5A20INS	(133) Tinned Copper, (21) Galvanized Steel		0.098 Ω/1,000 ft; 0.320 Ω/km	0.526 in (1.336 cm)	100% of 2/0 AWG (> 50 mm²)	200 ft (60 m)	135 lbs (62 kg)*	S5
CC5A30	(133) Tinned Copper, (24) Galvanized Steel		0.076 Ω/1,000 ft; 0.249 Ω/km	0.572 in (1.453 cm)	100% of 3/0 AWG (> 70 mm²)	200 ft (60 m)	135 lbs (62 kg)*	S6
CC5A30INS	(133) Tinned Copper, (24) Galvanized Steel		0.076 Ω/1,000 ft; 0.249 Ω/km	0.572 in (1.453 cm)	100% of 3/0 AWG (> 70 mm²)	200 ft (60 m)	172 lbs (78 kg)*	S6
CC5A30INSK	(133) Tinned Copper, (24) Galvanized Steel		0.076 Ω/1,000 ft; 0.249 Ω/km	0.572 in (1.453 cm)	100% of 3/0 AWG (> 70 mm²)	1000 ft (304 m)	678 lbs (368 kg)*	S6
CC5A40	(133) Tinned Copper, (28) Galvanized Steel		0.057 Ω/1,000 ft; 0.188 Ω/km	0.656 in (1.666 cm)	100% of 4/0 AWG (> 95 mm²)	200 ft (60 m)	172 lbs (79 kg)*	S7
CC5A40INS	(133) Tinned Copper, (28) Galvanized Steel		0.057 Ω/1,000 ft; 0.188 Ω/km	0.656 in (1.666 cm)	100% of 4/0 AWG (> 95 mm²)	200 ft (60 m)	199 lbs (91 kg)*	S7

*Weight does not include reel.

Connections to Theft Deterrent Composite Cable

ERITECH® HAMMERLOCK

Part Number	Conductor Size	Ground Rod
EHL58C2G	CC5A04 or CC5A05	Nominal 5/8" Copper-bonded
EHL34C2G	CC5A04 or CC5A05	Nominal 3/4" Copper-bonded

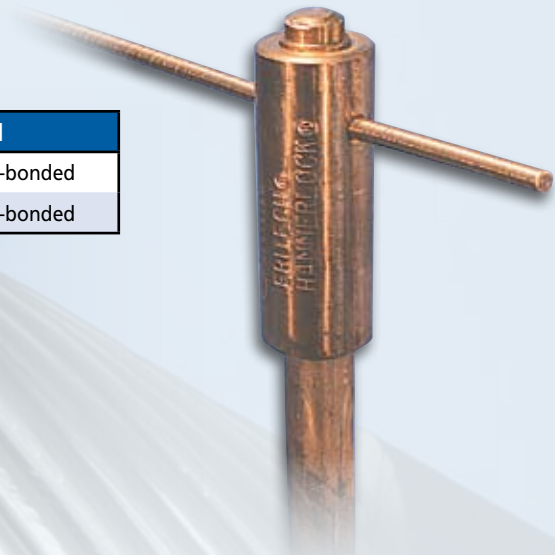

CADWELD® Connections

Conductor Size	Weld	CADWELD® Mold	Ground Rod or Lug	Welding Material	
CC5A04 or CC5A05	"SS" Style	SSCS1		32	
CC5A20		SSCS5		90	
CC5A30		SSCS6		115	
CC5A40		SSCS7		150	
CC5A04 or CC5A05	"GR" Style	GRC16S1	Nominal 5/8" Copper-bonded	65	
CC5A20		GRC16S5	Nominal 5/8" Copper-bonded	90	
CC5A30		GRC16S6	Nominal 5/8" Copper-bonded	90	
CC5A40		GRC16S7	Nominal 5/8" Copper-bonded	115	
CC5A04 or CC5A05		"GT" Style	GRC18S1	Nominal 3/4" Copper-bonded	90
CC5A20			GRC18S5	Nominal 3/4" Copper-bonded	90
CC5A30			GRC18S6	Nominal 3/4" Copper-bonded	90
CC5A40			GRC18S7	Nominal 3/4" Copper-bonded	115
CC5A04 or CC5A05	"GT" Style	GTC16S1	Nominal 5/8" Copper-bonded	90	
CC5A20		GTC16S5	Nominal 5/8" Copper-bonded	115	
CC5A30		GTC16S6	Nominal 5/8" Copper-bonded	150	
CC5A40		GTC16S7	Nominal 5/8" Copper-bonded	200	
CC5A04 or CC5A05		"GT" Style	GTC18S1	Nominal 3/4" Copper-bonded	90
CC5A20			GTC18S5	Nominal 3/4" Copper-bonded	115
CC5A30			GTC18S6	Nominal 3/4" Copper-bonded	150
CC5A40			GTC18S7	Nominal 3/4" Copper-bonded	200
CC5A04 or CC5A05	"GL" Style	GLCCES1	B121CE or B122CE	32	
CC5A20		GLCCES5	B121CE or B122CE	45	
CC5A30		GLCCES6	B121CE or B122CE	65	
CC5A40		GLCCES7	B121DE or B122DE	65	
CC5A04 or CC5A05	"LA" Style	LACS1CE	B101CEOL or B102CEOL	45	
CC5A20		LACS5CE	B101CEOL or B102CEOL	65	
CC5A30		LACS6CE	B101CEOL or B102CEOL	65	
CC5A40		LACS7DE	B101DEOL or B102DEOL	90	

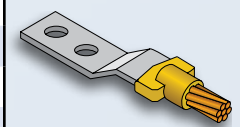
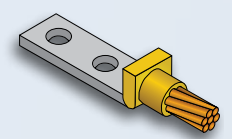
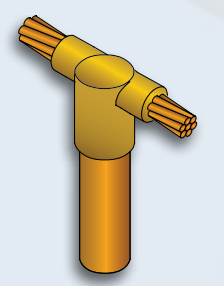
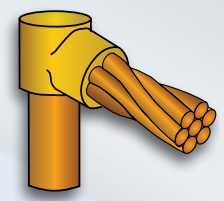
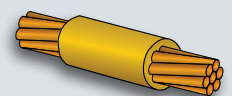

Cable Lugs

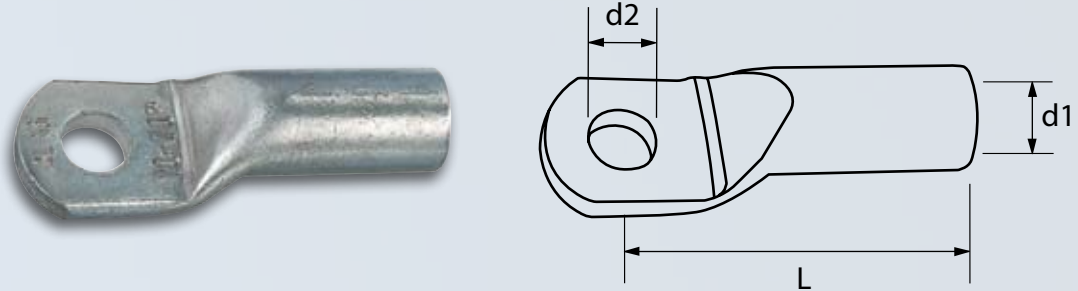

Tubular Crimping Lugs

Part Number	Description	Inside Dia. "d1"	Hole Dia. "d2"	Length "L"	Composite Cable Code	Std. Pkg. Unit	Approx. Weight 100 pc.
716654	LUG, CABLE, TUBULAR, RKS35/12	8.5 mm 0.335 in	13.0 mm 0.51 in	38 mm 1.30 in	CC5A04	100	2.12 kg 4.67 lbs
716655	LUG, CABLE, TUBULAR, RKS50/12	10.0 mm 0.394 in	13.0 mm 0.51 in	43 mm 1.70 in	CC5A05	50	3.23 kg 7.12 lbs
716557	LUG, CABLE, TUBULAR, RKS95/12	13.5 mm 0.531 in	13.5 mm 0.51 in	49 mm 1.93 in	CC5A20 or CC5A20INS	50	5.56 kg 12.26 lbs
715121	LUG, CABLE, TUBULAR, RKS120/12	15.0 mm 0.591 in	13.0 mm 0.51 in	51 mm 2.00 in	CC5A30 or CC5A30INS	50	6.38 kg 14.06 lbs
716659	LUG, CABLE, TUBULAR, RKS120/16	15.0 mm 0.591 in	17.0 mm 0.66 in	54 mm 2.12 in	CC5A30 or CC5A30INS	50	6.51 kg 14.35 lbs

Compression Cable Lugs, Heavy-Duty Version (DIN46235)

Part Number	Description	Inside Dia. "d1"	Hole Dia. "d2"	Length "L"	Composite Cable Code	Std. Pkg. Unit	Approx. Weight 100 pc.
715135	LUG, CABLE, COMP, PKS50/12-H	10.0 mm 0.394 in	13.0 mm 0.51 in	52 mm 2.05 in	CC5A04 & CC5A05	50	4.40 kg 9.70 lbs
715105	LUG, CABLE, COMP, PKS50/16-H	10.0 mm 0.394 in	17.0 mm 0.66 in	52 mm 2.05 in	CC5A04 & CC5A05	25	4.57 kg 10.08 lbs
715125	LUG, CABLE, COMP, PKS95/12-H	.531	13.0 mm 0.51 in	65 mm 2.56 in	CC5A20 or CC5A20INS	50	8.62 kg 19.00 lbs
715120	LUG, CABLE, COMP, PKS95/16-H	.531	17.0 mm 0.66 in	65 mm 2.56 in	CC5A20 or CC5A20INS	50	9.00 kg 19.84 lbs
715115	LUG, CABLE, COMP, PKS120/12-H	15.5 mm 0.610 in	13.0 mm 0.51 in	70 mm 2.76 in	CC5A30 or CC5A30INS	50	11.31 kg 24.93 lbs
715110	LUG, CABLE, COMP, PKS120/16-H	15.5 mm 0.610 in	17.0 mm 0.66 in	70 mm 2.76 in	CC5A30 or CC5A30INS	50	11.24 kg 24.78 lbs
715106	LUG, CABLE, COMP, PKS150/12-H	0.67	13.0 mm 0.51 in	78 mm 3.07 in	CC5A40 or CC5A40INS	25	16.29 kg 35.92 lbs
715122	LUG, CABLE, COMP, PKS150/16-H	.67	17.0 mm 0.66 in	78 mm 3.07 in	CC5A40 or CC5A40INS	10	16.17 kg 35.65 lbs

Cable Connections

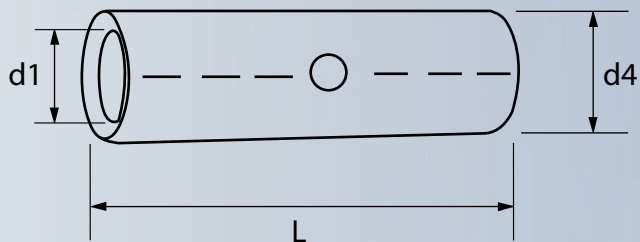

Cable Connectors Straight

Part Number	Description	Inside Dia. "d1"	Hole Dia. "d4"	Length "L"	Composite Cable Code	Std. Pkg. Unit	Approx. Weight 100 pc.
716714	CONNECTOR, CABLE, RKC35	8.5 mm 0.335 in	12.0 mm 0.470 in	45 mm 1.77 in	CC5A04	50	2.24 kg 4.94 lbs
716715	CONNECTOR, CABLE, RKC50	10.0 mm 0.394 in	14.0 mm 0.551 in	50 mm 1.97 in	CC5A05	50	3.36 kg 7.41 lbs
716717	CONNECTOR, CABLE, RKC95	13.5 mm 0.531 in	18.0 mm 0.709 in	60 mm 2.36 in	CC5A20 or CC5A20INS	25	5.91 kg 13.03 lbs
716718	CONNECTOR, CABLE, RKC120	15.0 mm 0.591 in	19.5 mm 0.767 in	65 mm 2.56 in	CC5A30 or CC5A30INS	25	7.00 kg 15.43 lbs

Cable Connectors, Heavy-Duty Version (DIN46247-1)

Part Number	Description	Inside Dia. "d1"	Hole Dia. "d4"	Length "L"	Composite Cable Code	Std. Pkg. Unit	Approx. Weight 100 pc.
716625	CONNECTOR, HEAVY, PKC50-H	10.0 mm 0.394 in	14.5 mm 0.570 in	56 mm 2.20 in	CC5A04 & CC5A05	50	4.26 kg 9.39 lbs
716627	CONNECTOR, HEAVY, PKC95-H	13.5 mm 0.531 in	19.0 mm 0.748 in	70 mm 2.76 in	CC5A20 or CC5A20INS	25	8.62 kg 19.00 lbs
716628	CONNECTOR, HEAVY, PKC120-H	15.5 mm 0.610 in	21.0 mm 0.826 in	70 mm 2.76 in	CC5A30 or CC5A30INS	25	9.66 kg 21.30 lbs
716629	CONNECTOR, HEAVY, PKC150-H	17.0 mm 0.669 in	23.5 mm 0.925 in	80 mm 3.15 in	CC5A40 or CC5A40INS	10	14.5 kg 31.97 lbs



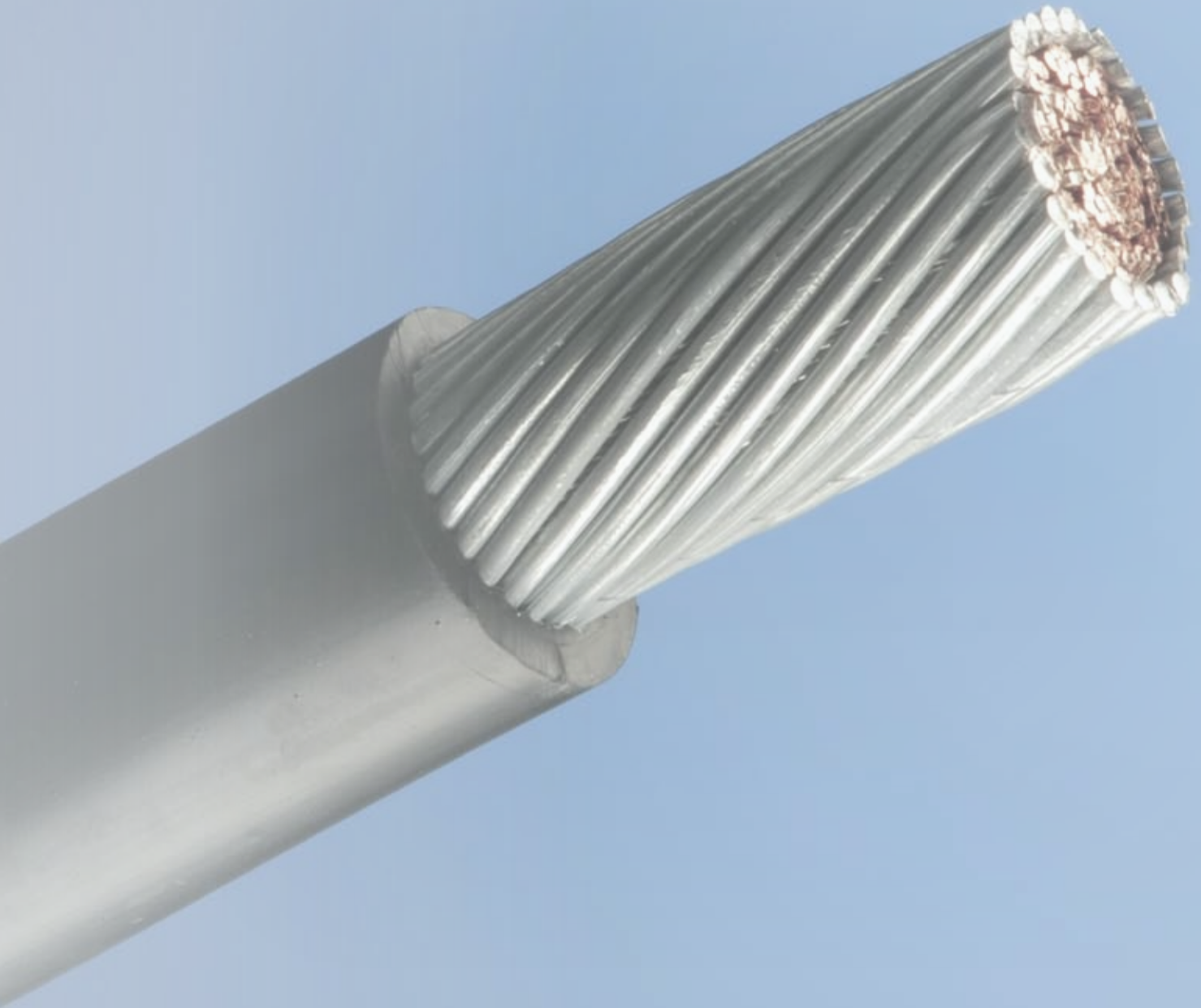

UL is a registered trademark of Underwriters Laboratories, Inc.

WARNING

ERICO products shall be installed and used only as indicated in ERICO's product instruction sheets and training materials. Instruction sheets are available at www.erico.com and from your ERICO customer service representative. Improper installation, misuse, misapplication or other failure to completely follow ERICO's instructions and warnings may cause product malfunction, property damage, serious bodily injury and death.

WARRANTY

ERICO products are warranted to be free from defects in material and workmanship at the time of shipment. NO OTHER WARRANTY, WHETHER EXPRESS OR IMPLIED (INCLUDING ANY WARRANTY OF MERCHANTABILITY OR FITNESS FOR A PARTICULAR PURPOSE), SHALL EXIST IN CONNECTION WITH THE SALE OR USE OF ANY ERICO PRODUCTS. Claims for errors, shortages, defects or nonconformities ascertainable upon inspection must be made in writing within 5 days after Buyer's receipt of products. All other claims must be made in writing to ERICO within 6 months from the date of shipment or transport. Products claimed to be nonconforming or defective must, upon ERICO's prior written approval in accordance with its standard terms and procedures governing returns, promptly be returned to ERICO for inspection. Claims not made as provided above and within the applicable time period will be barred. ERICO shall in no event be responsible if the products have not been stored or used in accordance with its specifications and recommended procedures. ERICO will, at its option, either repair or replace nonconforming or defective products for which it is responsible or return the purchase price to the Buyer. THE FOREGOING STATES BUYER'S EXCLUSIVE REMEDY FOR ANY BREACH OF ERICO WARRANTY AND FOR ANY CLAIM, WHETHER SOUNDING IN CONTRACT, TORT OR NEGLIGENCE, FOR LOSS OR INJURY CAUSED BY THE SALE OR USE OF ANY PRODUCT.

LIMITATION OF LIABILITY

ERICO excludes all liability except such liability that is directly attributable to the willful or gross negligence of ERICO's employees. Should ERICO be held liable its liability shall in no event exceed the total purchase price under the contract. ERICO SHALL IN NO EVENT BE RESPONSIBLE FOR ANY LOSS OF BUSINESS OR PROFITS, DOWNTIME OR DELAY, LABOR, REPAIR OR MATERIAL COSTS OR ANY SIMILAR OR DISSIMILAR CONSEQUENTIAL LOSS OR DAMAGE INCURRED BY BUYER.

ERICO®



www.erico.com



AUSTRALIA
Phone 1-800-263-508
Fax 1-800-423-091

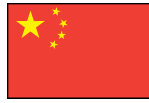

CHINA
Phone +86-21-3430-4878
Fax +86-21-5831-8177



HUNGARY
Phone 06-800-16538
Fax +39-0244-386-107



NORWAY
Phone 800-100-73
Fax 800-100-66



SWITZERLAND
Phone 0800-55-86-97
Fax 0800-55-96-15



BELGIUM
Phone 0800-757-48
Fax 0800-757-60



DENMARK
Phone 808-89-372
Fax 808-89-373



INDONESIA
Phone +62-21-575-0941
Fax +62-21-575-0942



POLAND
Phone +48-71-349-04-60
Fax +48-71-349-04-61



THAILAND
Phone +66-2-267-5776
Fax +66-2-636-6988



BRAZIL
Phone +55-11-3623-4333
Fax +55-11-3621-4066



FRANCE
Phone 0-800-901-793
Fax 0-800-902-024



ITALY
Phone 800-870-938
Fax 800-873-935



SINGAPORE
Phone +65-6-268-3433
Fax +65-6-268-1389



UNITED ARAB EMIRATES
Phone +971-4-881-7250
Fax +971-4-881-7270



CANADA
Phone 1-800-677-9089
Fax 1-800-677-8131



GERMANY
Phone 0-800-189-0272
Fax 0-800-189-0274



MEXICO
Phone +52-55-5260-5991
Fax +52-55-5260-3310



SPAIN
Phone 900-993-154
Fax 900-807-333



UNITED KINGDOM
Phone 0808-2344-670
Fax 0808-2344-676



CHILE
Phone +56-2-370-2908
Fax +56-2-369-5657



HONG KONG
Phone +852-2764-8808
Fax +852-2764-4486



NETHERLANDS
Phone 0800-0200-135
Fax 0800-0200-136



SWEDEN
Phone 020-790-908
Fax 020-798-964



UNITED STATES
Phone 1-800-753-9221
Fax +1-440-248-0723